

**VMS 1 DURING**

DE BURGH ST

ONE WAY

---

FOLLOW

DETOUR

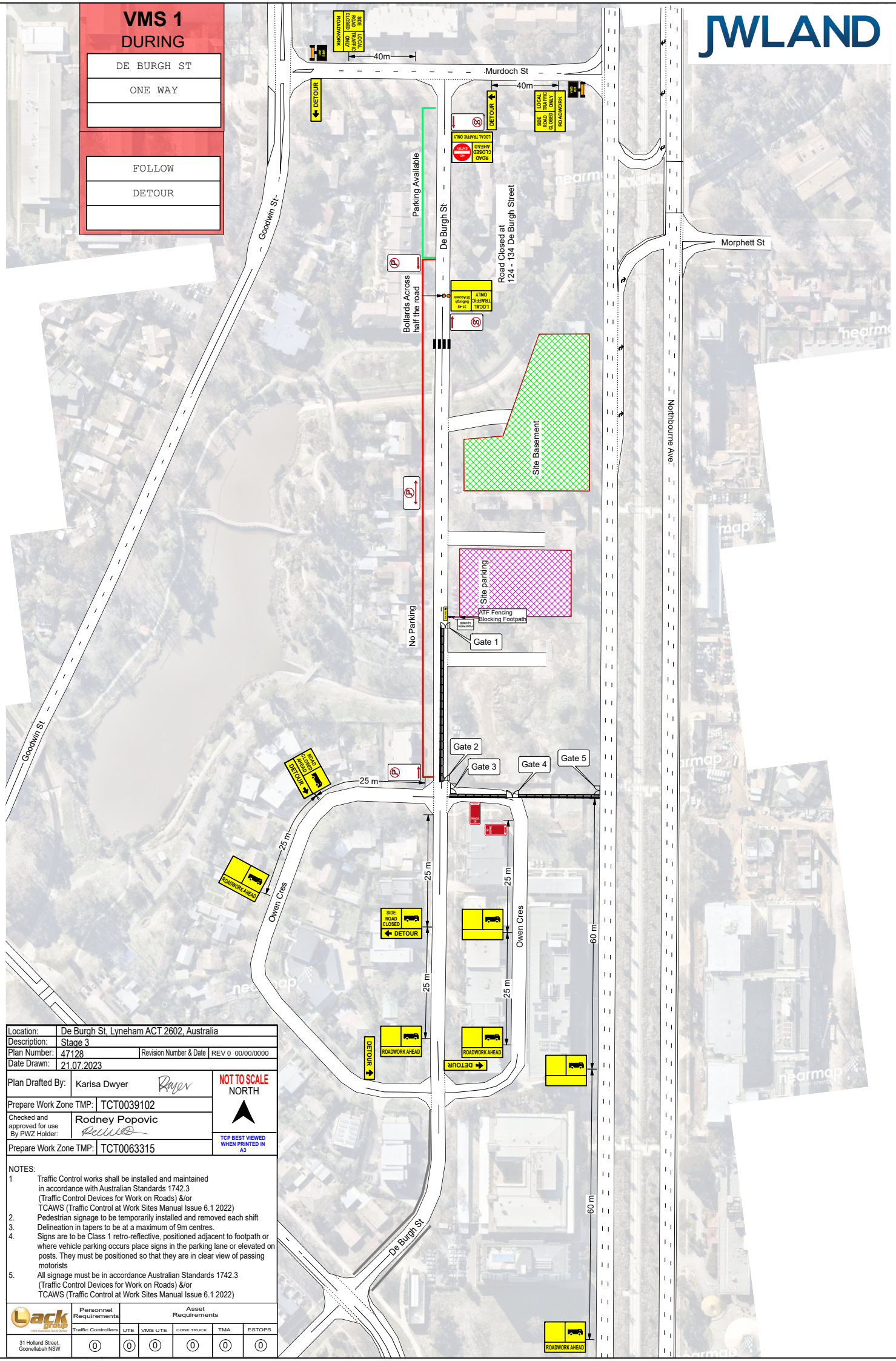

|   |  |   |                  |  |  |
|---|--|---|------------------|--|--|
| Location:                                   | De Burgh St, Lyneham ACT 2602, Australia |   |                  |  |  |
| Description:                                | Stage 3                                  |   |                  |  |  |
| Plan Number:                                | 47128                                    | Revision Number & Date:   | REV 0 00/00/0000 |  |  |
| Date Drawn:                                 | 21.07.2023                               |   |                  |  |  |
| Plan Drafted By:                            | Karisa Dwyer                             | <p><b>NOT TO SCALE</b></p> <p><b>NORTH</b></p> <p><b>TCP BEST VIEWED WHEN PRINTED IN A3</b></p> |                  |  |  |
| Prepare Work Zone TMP:                      | TCT0039102                               |   |                  |  |  |
| Checked and approved for use By PWZ Holder: | Rodney Popovic                           |   |                  |  |  |
| Prepare Work Zone TMP:                      | TCT0063315                               |   |                  |  |  |

- NOTES:**
- 1 Traffic Control works shall be installed and maintained in accordance with Australian Standards 1742.3 (Traffic Control Devices for Work on Roads) &/or TCAWS (Traffic Control at Work Sites Manual Issue 6.1 2022)
  - 2 Pedestrian signage to be temporarily installed and removed each shift
  - 3 Delineation in tapers to be at a maximum of 9m centres.
  - 4 Signs are to be Class 1 retro-reflective, positioned adjacent to footpath or where vehicle parking occurs place signs in the parking lane or elevated on posts. They must be positioned so that they are in clear view of passing motorists
  - 5 All signage must be in accordance Australian Standards 1742.3 (Traffic Control Devices for Work on Roads) &/or TCAWS (Traffic Control at Work Sites Manual Issue 6.1 2022)

|                                       |                        |                    |          |            |     |        |
|---------------------------------------|------------------------|--------------------|----------|------------|-----|--------|
| <p>31 Holland Street, Gosford NSW</p> | Personnel Requirements | Asset Requirements |          |            |     |        |
|                                       | Traffic Controllers    | UTE                | VMS LITE | CONE TRUCK | TMA | ESTOPS |
|                                       | 0                      | 0                  | 0        | 0          | 0   | 0      |